

WS Abrundfräser

Fraises à arrondir avec plaquettes réversibles

Rounding cutters with profile inserts

MAN

5.418

D	B	d	Z	R	n	Fräser	Set
132	20	30	2	3-4-5-6-8-10	5200-8000		500.-
132	20	30	2	3-4-5-6-8-10	5200-8000	360.-	
167	30	30	2	12-15-18-20	4600-7300	420.-	

Profilplatten – Plaquettes – Inserts

20 x 24 x 2 mm	3 – 10	40.-
30 x 34 x 2 mm	12 – 20	60.-

Passender Anlauftring D110/125 mm – Bagues d'appui – Ball bearing guide

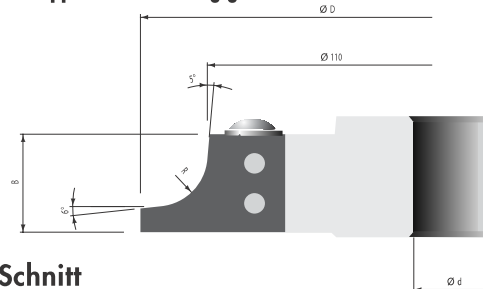
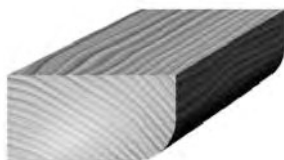

Viertelstabfräser mit ziehendem Schnitt

Fraises à quart de rond

Quarter round cutters

MAN

1.086

D	B	d	Z	R	n	HM
120	15	30	2	3	6500-11100	390.-
120	15	30	2	4	6500-11100	390.-
120	15	30	2	5	6500-11100	390.-
120	15	30	2	6	6500-11100	390.-
120	18	30	2	8	6500-11100	400.-
120	18	30	2	9	6500-11100	400.-
120	18	30	2	10	6500-11100	400.-
120	20	30	2	12	6500-11100	420.-
120	25	30	2	15	6500-11100	460.-
140	30	30	2	20	5500-9400	490.-
140	35	30	2	25	5500-9400	540.-
160	40	30	2	30	4800-8400	600.-
170	45	30	2	35	4500-7700	680.-
180	50	30	2	40	4000-6500	730.-
200	60	30	2	50	3400-6000	830.-



WS Viertelstabfräser

Fraises à quart avec plaquettes réversibles

Quarter round cutters with carbide profile inserts

Profilplatte

Plaquettes

Inserts

D	B	d	Z	R	n	HM	2 mm
140	15	30	2	7,5	5500-9500	360.-	43.-
140	20	30	2	10	5500-9500	360.-	46.-
140	20	30	2	12,5	5500-9500	380.-	46.-
140	25	30	2	15	5500-9500	420.-	50.-
160	30	30	2	20	4800-8300	440.-	56.-
190	60	30	3	25	4100-6000	790.-	65.-
190	60	30	3	30	4100-6000	790.-	65.-
210	80	30	3	40	3700-5400	860.-	80.-
230	100	30	3	50	3400-4900	925.-	86.-

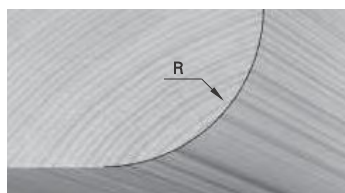
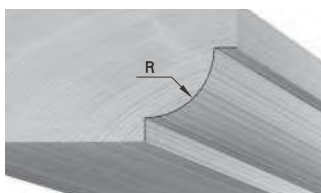

WS Viertelstab-Hohlkehlfräser
Fraise à quart de rond-gorge
Double radius cutters

MAN 1.092

D	B	d	Z	R	n	HM	Profilplatte
106	20	30	2	3	7300–10100	241.–	41.–
110	20	30	2	5	7000–9900	241.–	41.–
112	20	30	2	6	6900–9700	241.–	41.–
116	20	30	2	8	6600–9500	262.–	41.–
120	25	30	2	10	6400–9500	277.–	55.–
124	30	30	2	12	6200–9500	335.–	59.–
130	35	30	2	15	5900–9500	376.–	63.–
140	50	30	2	20	5500–9000	418.–	79.–
150	60	30	2	25	5100–6000	523.–	106.–
160	60	30	2	30	4900–5800	554.–	106.–



Passender Anlaufring D100 mm – Bagues d'appui – Ball bearing guide

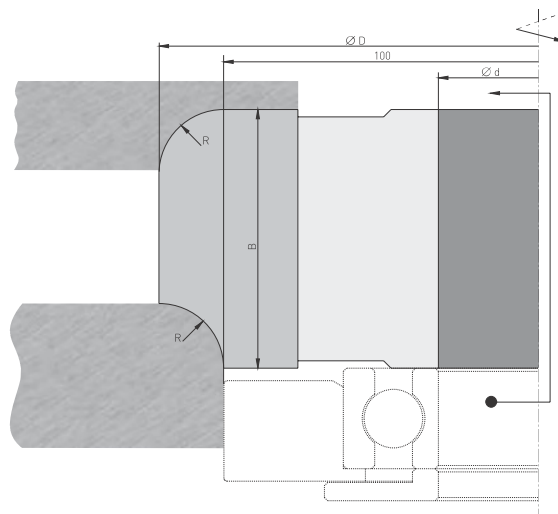

Griffmuldenfräser
Fraise pour poignées
Profile cutter for drawer fronts

MAN 1.300

Messerkopf mit HM Profilplatten / Porte-outil avec plaquettes profilées

D	B	d	Z	T	n	Profil	HM	Profilplatte
160	20	30	2	50	5500–9500	A5	460.–	50.–
160	20	30	2	50	5500–9500	Satz A5, A2, A3, A4	700.–	50.–



Profilfräser HM bestückt / Fraise profilée rapporté HM

D	B	d	Z	T	n	Profil	HM
140	20	30	2	40	5500–9500	R = 5,5 mm	490.–

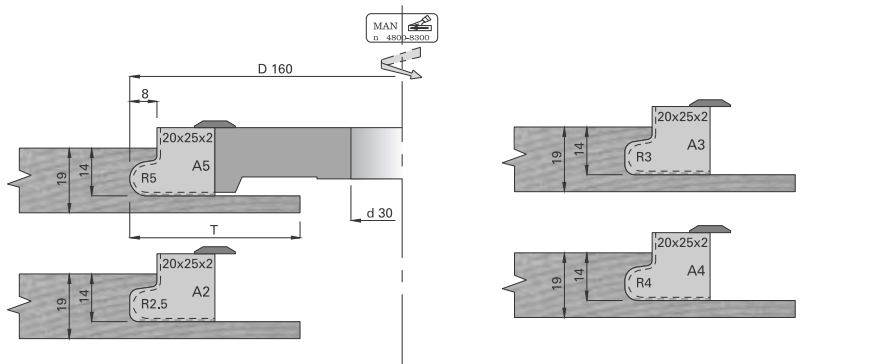

Handlauf-Profilfräser
Fraises à main courante
Profile cutters for hand rails

MAN 1.005

D	B	d	Z	n	HSS
160	63	30	2	4800-8500	690.-

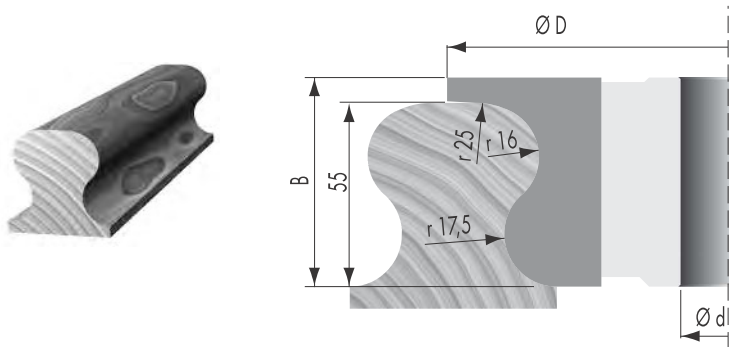

D	B	d	Z	n	HM
140	70	30	2	5500-9500	590.-
Profilplatte – Plaquette – Insert				75 x 34,5 x 2	80.-

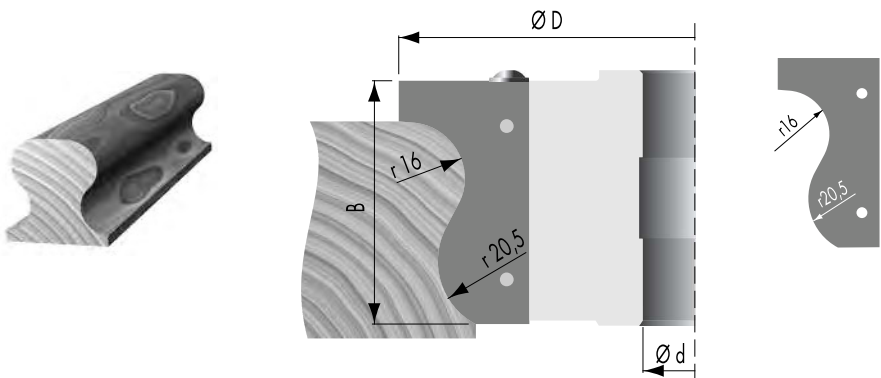

WS Top Profiler
Fraises à profils multiples
Multi-profile cutters

MAN 1.007

D	B	d	Z	n	HM	Profilplatte
120	40	30	2	6400-10000	303.-	66.-
160	50	30	2	4800-8300	423.-	80.-

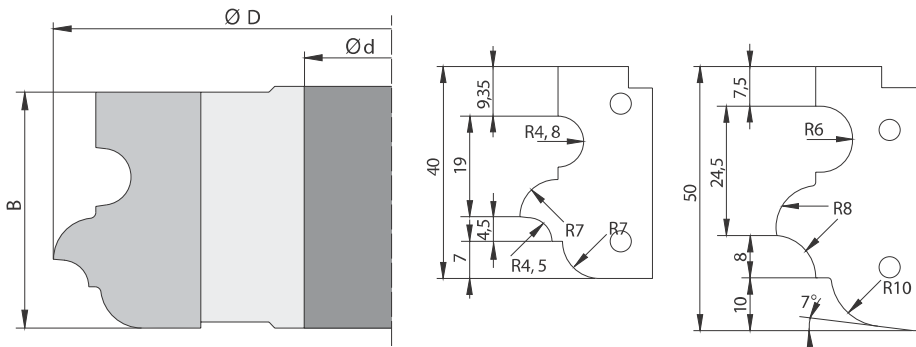

WS Abrundfräser
Fraises pour arrondissement
Rounding cutter heads

MAN 5.414

D	B	d	Z	n	Radius	HM
140	32	30	2	5400-8800	2, 3, 5	319.-
180	50	30	2	4500-7500	4, 6, 8, 10	408.-
Profilplatte – Plaquette – Insert				25 x 16 x 2	2, 3, 5	36.-
				50 x 16 x 2	4, 6, 8, 10	56.-

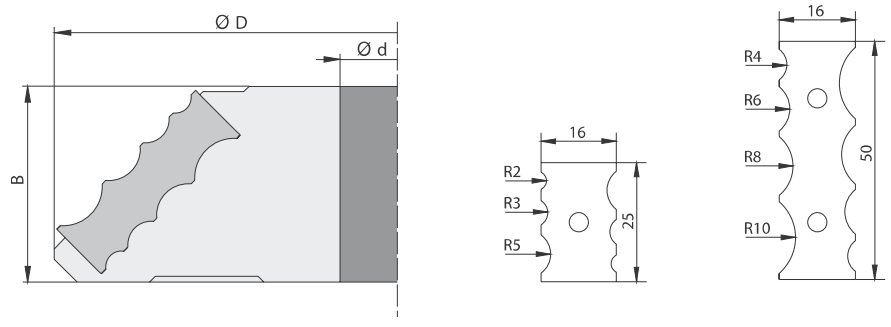

WS Fase-Abrundfräasersatz
Porte-outils pour chanfreiner et arrondir
Chamfer and rounding cutter set

MAN CMT 694.005

D	B	d	Z	R	n	HM
125	18-50	30	3 x 2	2-3-4-5-6	5500-9400	696.-

Paar Ersatzschneiden – couteaux	oben	unten	HM
R = 2 mm + 45° 20 x 21 x 2 mm	695.005.A2	695.005.B2	60.-
R = 3 mm + 45° 20 x 21 x 2 mm	695.005.A3	695.005.B3	60.-
R = 4 mm + 45° 20 x 21 x 2 mm	695.005.A4	695.005.B4	60.-
R = 5 mm + 45° 20 x 21 x 2 mm	695.005.A5	695.005.B5	60.-
R = 6 mm + 45° 20 x 21 x 2 mm	695.006.A6	695.006.B6	60.-

