

Kombi-, Nut- und Kammfräser-Garnitur
Jeu de fraises pour rainures et languettes
Combination tongue and groove cutter set

MAN 1.232

D	B	d	Z	Fräser	n	HM
156,7	24,5	30	2	01	4700-8300	
160	20,8	30	2	02	4700-8300	
160	20,8	30	2	03	4700-8300	
157	25	30	2	04	4700-8300	
160	17	30	2	05	4700-8300	
kompletter Satz – Jeu – Set				01-05	4700-8300	1150.-

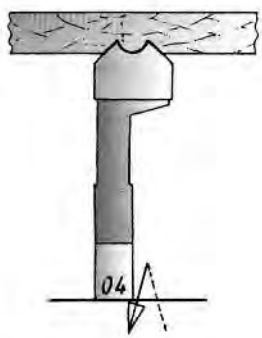
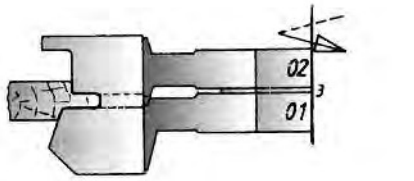
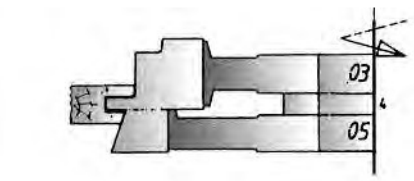
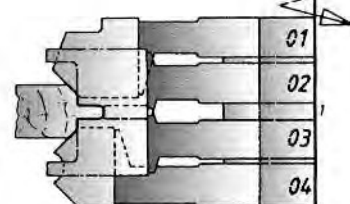
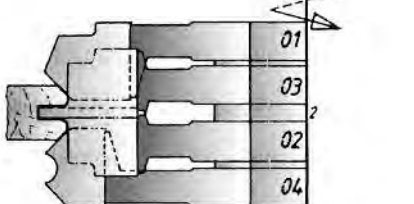
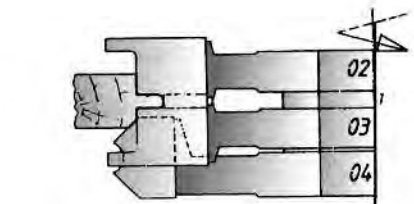
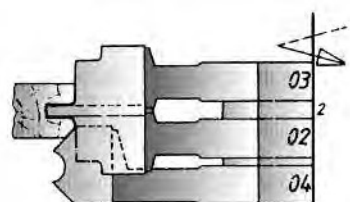
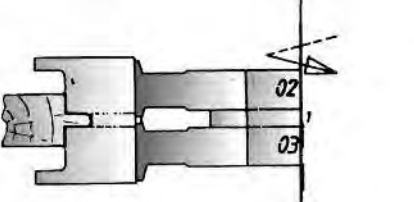
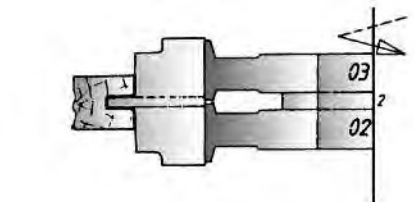
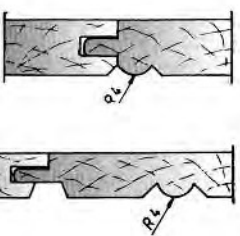
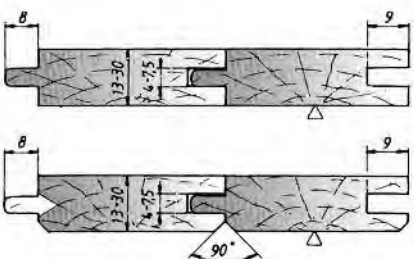
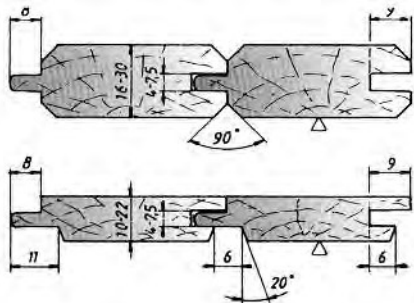

WS Nut- und Kammfräsersatz
 Jeu de fraises pour rainure et bouvetage
 Insert tongue and groove cutters set

MAN 1.230

D	B	d	Z	V	Fräser	n	HM
143	20	30	2	2	1	4700-8300	
160	5	30	4	4	2	4700-8300	
142	20	30	2	2	3	4700-8300	
160	20	30	2	2	4	4700-8300	
kompletter Satz – Jeu – Set					1-4	4700-8300	1125.-

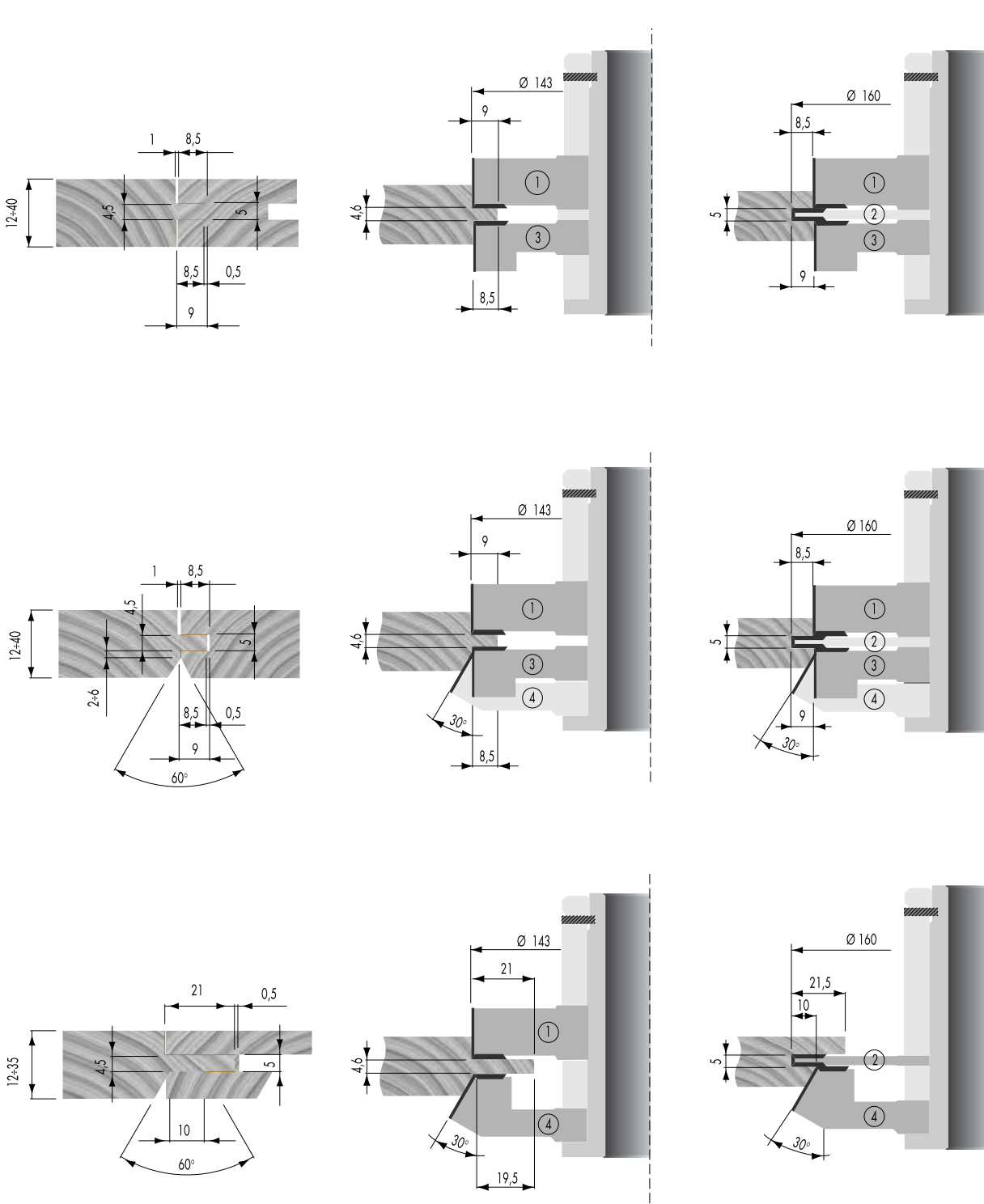

ECO-Vollstahl Nut- und Kammfräser
Fraises solides pour rainure et bouvetage
Solid HSS steel tongue and groove cutters

MEC

Hochwertige HSS-ECO-Vollstahlfräser mit Radialhinterschliff für hohe Standzeiten. Garnitur bestehend aus Nut- und Kammfräsersatz für Vierseiten-automaten verstellbar mit Ringen.

Fraises en acier HSS-ECO solides avec détalonnage radial pour machines à quatre faces. Jeu comprenant fraise à rainurer et fraise à crêter réglables par bagues.

Solid high speed steel cutters with radial back clearance for moulders. Set consisting of tongue and groove cutter adjustable with spacers.



Bodenriemen – Lames de plancher – Flooring cutters

2.015

Profil	D	B	d	Z	nmax	HSS-ECO
015.35	160	40	40/60	6	9000	2680.–
015.35	180	40	40/60	6	8000	2780.–
015.40	160	55	40/60	6	9000	2940.–
015.40	180	55	40/60	6	8000	3050.–

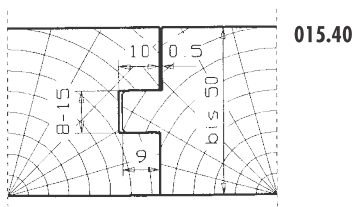
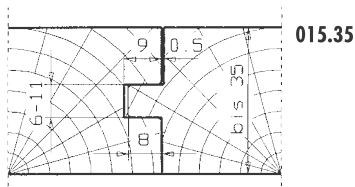

Fasetäfer – Lames à chanfrein – Chamfered paneling

2.025

Profil	D	B	d	Z	nmax	HSS-ECO
025.16	160	30	40/60	6	9000	2890.–
025.16	180	30	40/60	6	8000	3000.–
025.20	160	38	40/60	6	9000	3100.–
025.20	180	38	40/60	6	8000	3300.–

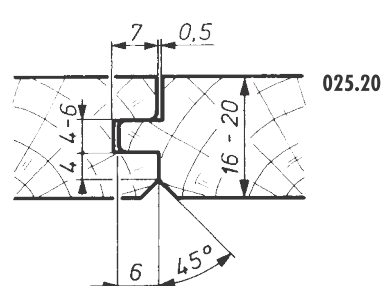
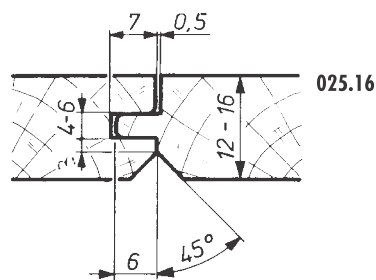

Nutentäfer – Lambris à élégi – Chamfered paneling

2.035

Profil	D	B	d	Z	nmax	HSS-ECO
035.23	180	38	40/60	6	8000	3300.–
035.25	180	38	40/60	6	8000	3400.–

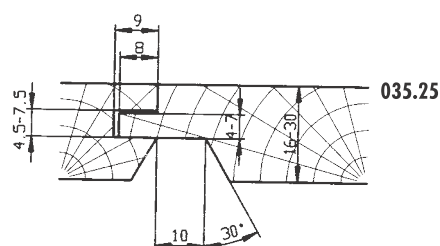
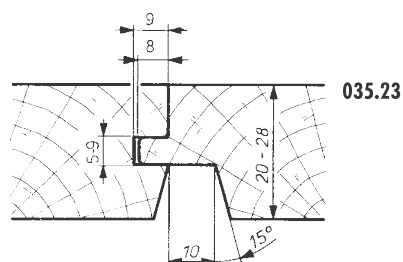

HSS-bestückte Nut- und Kammfräser
 Fraises pour rainure et bouvetage rapportées en HSS
 HSS-tipped tongue and groove cutters

MEC 2.020

Profil	D	B	d	Z	n _{max}	HSS-B
A	140	35	40	4	105000	1800.-
B	180	35	40/60	6	8000	2520.-
C	180	35	40/60	6	8000	2840.-
D	180	35	40/60	6	8000	2540.-
E	180	35	40/60	6	8000	3060.-

