

**Verleimfräser**  
**Fraises pour joints collés**  
**Glue joint cutters**

**MAN 1.181/1.190**

D	B	d	Z	Profil	n	HSS	HM
140	50	30	2	A	5500-9500	<b>560.-</b>	<b>560.-</b>
140	60	30	2	B	5500-9500	<b>620.-</b>	<b>620.-</b>
140	80	30	2	C	5500-9500	<b>690.-</b>	<b>690.-</b>
120	60	30	2	D	5500-9500		<b>490.-</b>
120	100	30	2	D	5500-9500		<b>650.-</b>

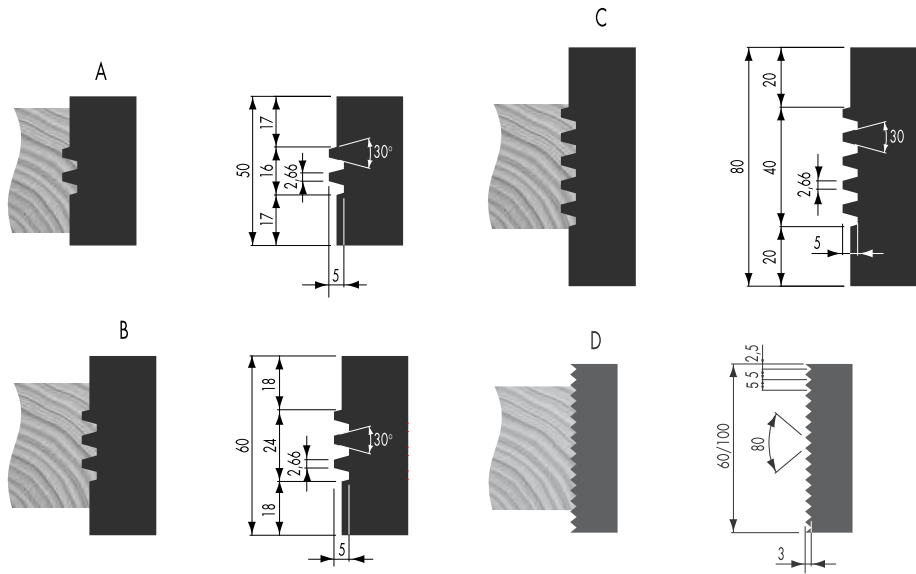

**WS Verleimfräser**  
**Porte-outil pour joints collés**  
**Glue joint cutter heads**

**MAN 5.460**

D	B	d	Z	Profil	n	Alu	Stahl	Profilplatte
130	50	30	2	A	5900-9000	<b>439.-</b>	<b>533.-</b>	<b>90.-</b>
130	60	30	2	B	5900-9000	<b>460.-</b>	<b>559.-</b>	<b>100.-</b>
130	60	30	2	E	5900-9000	<b>460.-</b>		<b>100.-</b>
130	80	30	2	C	5900-9000		<b>680.-</b>	<b>140.-</b>

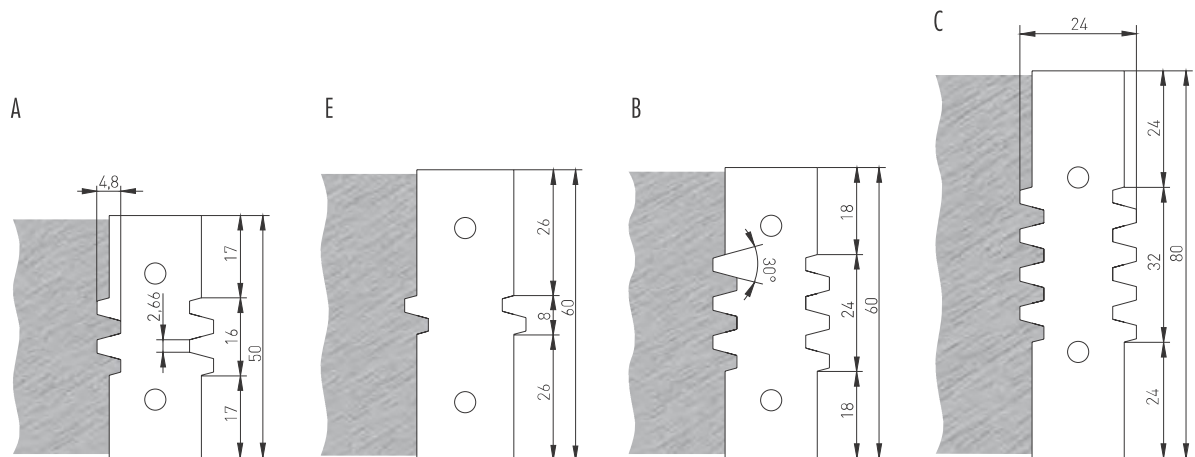

**WS Verleimfräser**  
**Porte-outils pour joints collés**  
**Glue joint cutter heads**

**MAN 5.461**

D	B	d	Z	Holz	n	HM	Profilplatte
140	60	30	2	16-58	5500-9500	460.-	60.-

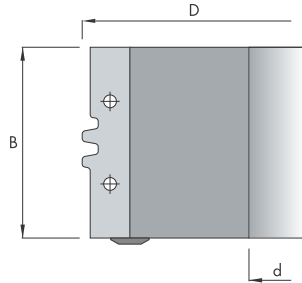
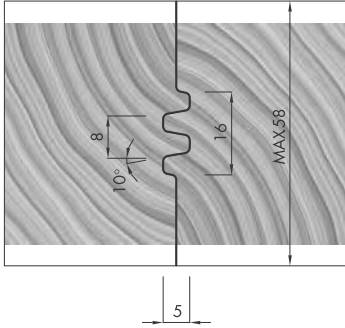

**WS Verleimfräser**  
**Porte-outils pour joints collés**  
**Glue joint cutter heads**

**MAN 5.463**

D	B	d	Z	Holz	n	HM	Profilplatte
125	60	30	2	max. 55	6200-10700	360.-	46.-
125	80	30	2	max. 75	6200-10700	500.-	60.-

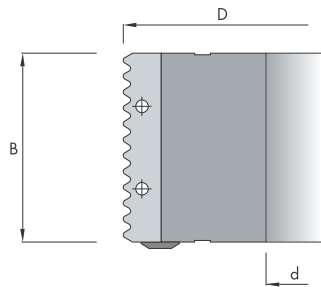
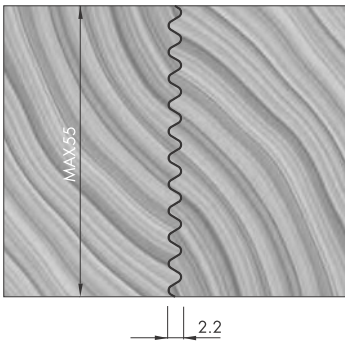

**Verleimfräser**  
**Porte-outils pour joints collés**  
**Glue joint cutter heads**

**MAN 5.464**

D	B	d	Z	Holz	n	HM	WS	Profilplatte
140	80	30	3	42-78	5500-9500		780.-	100.-
120	30	30	2	15-28	5500-9500	500.-		

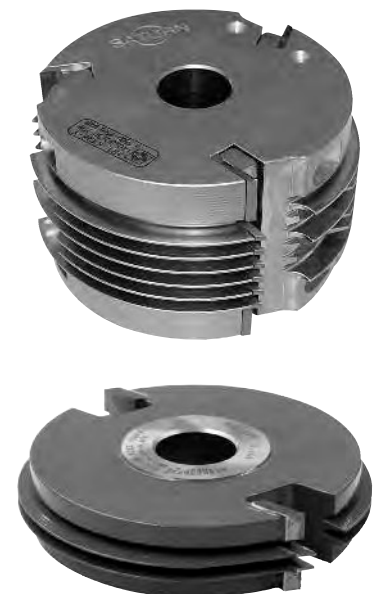
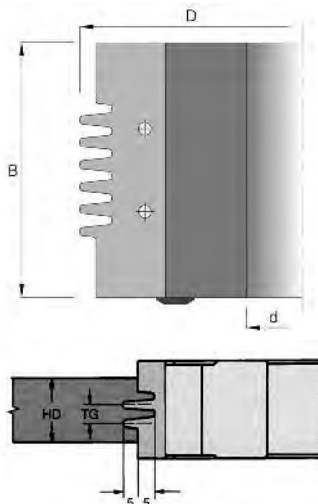
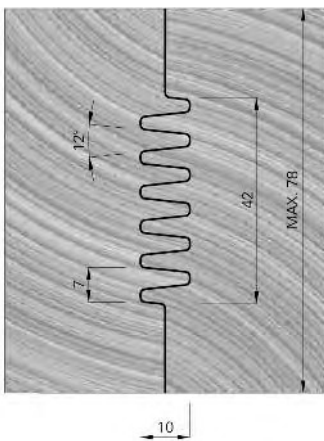

**WS Gehrungs-Verleimfräser**  
**Porte-outils à bouvetage 45°**  
**Insert mitre glue joint cutters**

**MAN 5.465**

Selbsthemmende 45° Gehrungs-Verleimverbindung für Holzstärken von 13 bis 35 mm. Ein Werkstück wird in horizontaler, das andere in vertikaler Lage gefräst.

Porte-outils à bouvetage 45° sur bois avec épaisseur de 13 à 35 mm. La jonction se réalise en travaillant les pièces dans le sens horizontal et vertical. Profil auto-serrant.

Mitre glue joint cutters for wood width 13 to 35 mm. The joint is made by working one piece in horizontal and one piece in vertical direction. Profil auto-serrant.

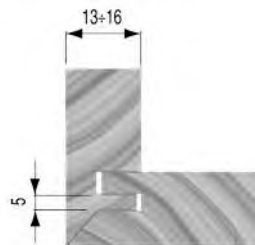
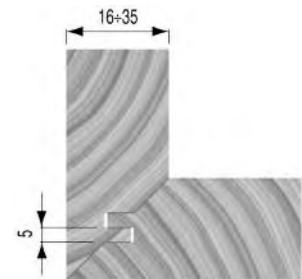

D	B	d	Z	V	n	Nut	Stahl
170	52	30	4 + 2	2	4300-7400	2	<b>790.-</b>

**Ersatzteile – Pièces de rechange – Spares**

9.020	9.114	600705	600719
20 x 12 x 1,5	14 x 14 x 2	48 x 16 x 5	40 x 20 x 5
		MEC	MAN
<b>5.-</b>	<b>4.50</b>	<b>72.-</b>	<b>78.-</b>

**Gehrungs-Verleimfräser**  
**Porte-outils à bouvetage 45°**  
**Insert mitre glue joint cutters**

**MAN 5.467**

D	B	d	Z	Holz	n	HM	WS	Profilplatte
180	56	30	2	12-40	4300-7400		<b>600.-</b>	<b>56.-</b>
160	24	30	2	9-20	4800-8300	<b>592.-</b>		
180	44	30	2	12-40	4300-7400	<b>750.-</b>		
210	55	30	2	15-50	3500-6100	<b>880.-</b>		

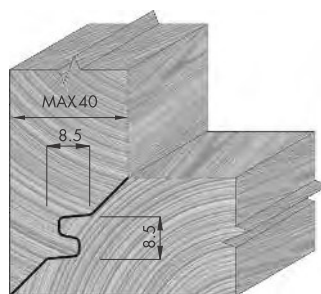

Beispiel WS

**Minizinkenfräser**  
**Fraises de mini-aboutage**  
**Mini finger joint cutters**

**MEC 1.187**

Profil 4 mm					ohne Messer sans couteaux without knives
D	B	d	Z	nmax	
138/160	25,6	30/50	4	8000	<b>358.-</b>
226/250	25,6	30/50	6	5500	<b>550.-</b>

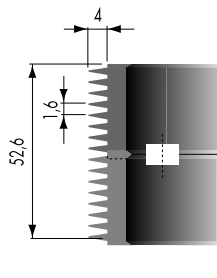

Profil 10/10 + 10/11 mm					ohne Messer sans couteaux without knives
D	B	d	Z	nmax	
129/160	30,4	30/50	4	8500	<b>330.-</b>
216/250	30,4	30/50	6	5500	<b>488.-</b>

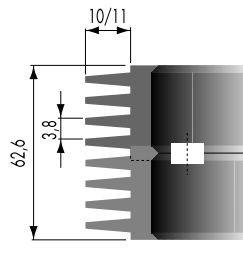

Profil 15/15 + 15/16,5 mm					ohne Messer sans couteaux without knives
D	B	d	Z	nmax	
149/170	30,4	30/50	4	8000	<b>474.-</b>
235/260	30,4	30/50	6	5200	<b>706.-</b>

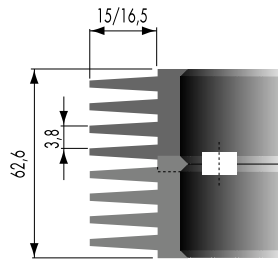

Profil 20/20 + 20/22 mm					ohne Messer sans couteaux without knives
D	B	d	Z	nmax	
152/180	37,2	30/50	4	7500	<b>502.-</b>
232/260	37,2	30/50	6	5200	<b>743.-</b>

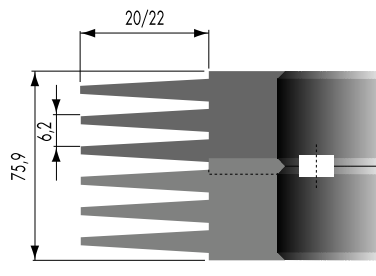

Messer – Couteaux – Knives			
Profil	Dimension	TiAlN	HM
4	25,4 x 33 x 14/36/36	<b>136.-</b>	
10/10	28,4 x 38,5 x 14/24/24	<b>124.-</b>	<b>232.-</b>
10/11	28,4 x 38,5 x 14/24/24	<b>124.-</b>	<b>232.-</b>
15/15	28,4 x 43,5 x 14/28/28	<b>128.-</b>	
15/16,5	28,4 x 43,5 x 14/28/28	<b>128.-</b>	
20/20	32,5 x 48,5 x 14/36/36	<b>136.-</b>	
20/22	32,5 x 48,5 x 14/36/36	<b>136.-</b>	

